



QSY 88 UTILITY/LINE HANDLING VESSEL

Vessel Characteristics

Length, Overall:	88.9 ft	271 m
Beam:	20 ft	6.1 m
Depth:	11.5 ft	3.5 m
Maximum Draft:	7.9 ft	2.4 m
Minimum Height:	31.8 ft	9.7 m
Freeboard:	4.6 ft	1.4 m
Displacement:	160 lt	170 mt
Deadweight:	50 lt	50 mt
Clear Deck Space:	36 x 15 ft	11 x 4.6 m
Clear Deck Area:	530 ft²	49 m²
Deck Strength:	230 lb/ft²	1.1 t/m²
Class Notations:	ABS: +A1,HSC,LAUNCH,+AMS	

Capacities

Deck Cargo:	10 lt	10 t
Fuel Oil:	5,900 gal	22.3 m³
Potable Water:	3,150 gal	11.9 m³
Drill/Ballast Water:	3,220 gal	12.2 m³
Oil Dispersant:	470 gal	1.8 m³

TIDEWATER

Find out more

tdw.com

Pg.2 Further Specifications
Pg.3 General Arrangement

Pg.4 Capacity Table

NOTICE: The data contained herein is provided for convenience of reference to allow users to determine the suitability of the Company's equipment. The data may vary from the current condition of equipment which can only be determined by physical inspection. Company has exercised due diligence to insure that the data contained herein is reasonably accurate. However, Company does not warrant the accuracy or completeness of the data. In no event shall Company be liable for any damages whatsoever arising out of the use or inability to use the data contained herein.



Machinery

Main Engines (2):	Cummins KTA 50 M2		
Total HP:	3,600		
Propellers (2):	4 Blade, 472 x 44.5		
Primary Generators (2):	75 kw	220 v	60 hz
Driven by:	Cummins 6BT5.9G1M		

Performance*

Fuel Consumption Vs Speed	
Maximum:	15 m ³ /day (160 gph) @ 17 knots
Standby:	0.6 m ³ /day (6.1 gph) @ 0 knots

Registration

Flag: VANUATU	Home Port: PORT VILA
Hull Number: 1229	IMO N^o: 9243942
Year Built: 2000	Call Sign: YJRQ8
Builder:	QUALITY SHIPYARDS
Tonnage (ITC):	130 GT 39 NT

Nav/Comms Equipment

Radar(s):	2
Depth Sounder:	1
Cyro Compass:	1
Radio:	2 x VHF; 1 x SSB

Accommodations

No. of Berths:	8
Cabins:	2x2-man & 1x4-man
Passenger Seats:	12
Certified to Carry:	20
Galley seating:	6

Deck Equipment

Anchors (1):	65 lbs Fortress
Crane:	2 t @ 3.7 m
Capstans (2):	9.1 t Schoellhorn Albrecht

Special Equipment

Firefighting:	1x 270 m ³ /hr Fire Monitor
Oil Dispersant Equipment:	2 x 6m Booms (P/S)
Misc:	Push Bow; MSD-3 Persons; *Fuel shown is for Ship's use only..

*Approximate values assuming Ideal Conditions

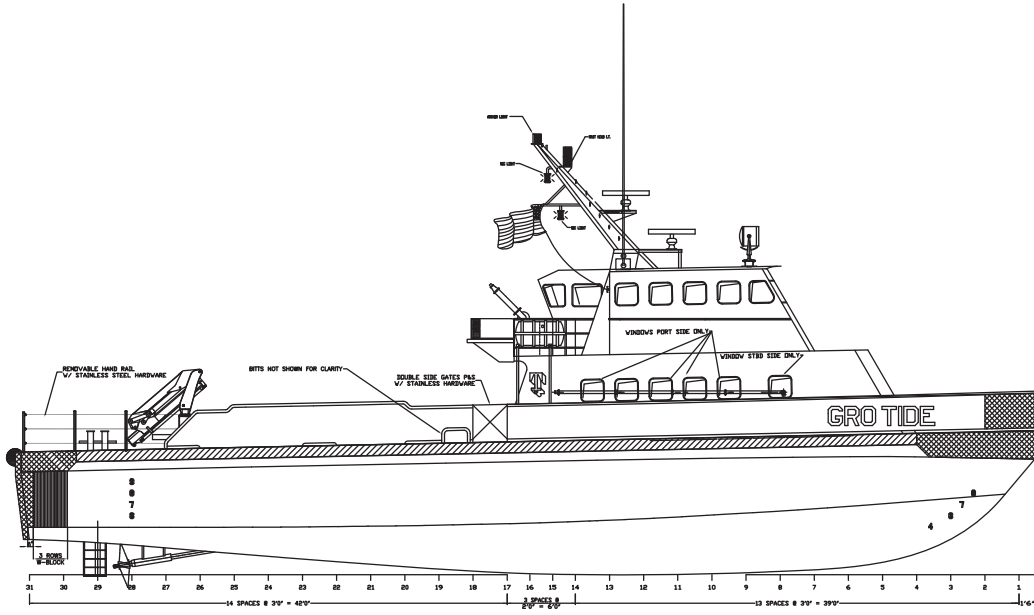

OUTBOARD PROFILE

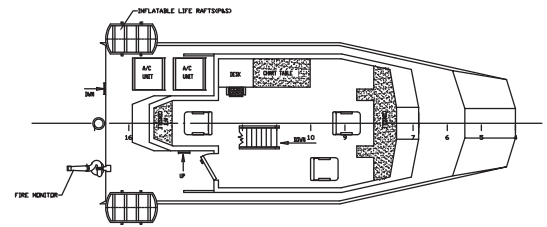

BRIDGE DECK

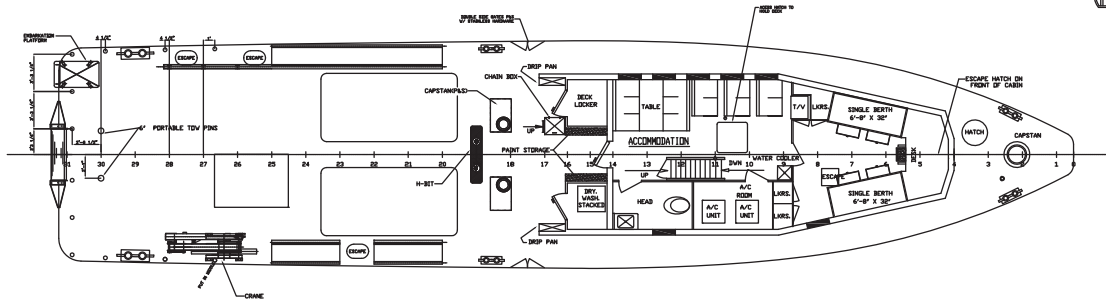

MAIN DECK

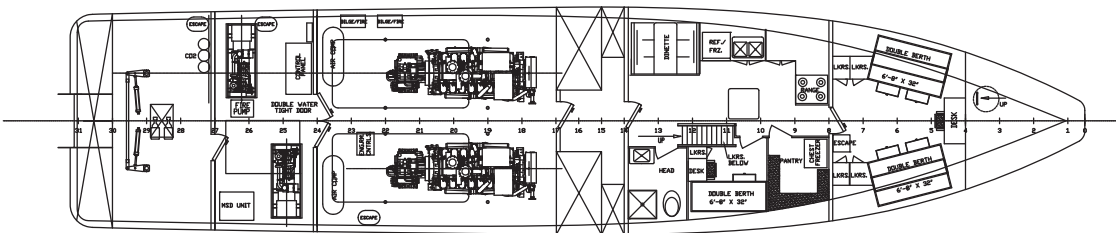

BELOW MAIN DECK

GRO TIDE

Capacity Table



Tank	Contents	Volume m ³	Base Oil	Fuel Oil	Dry Bulk	DW/WB	Potable Water	Fresh Water	Brine	Liquid Mud	Methanol	Lube Oil	Foam	Oil Disp.
FP Ballast Tank	DW/WB	12.2				12.2								
FO Tank C	FO	9.0		9.0										
FO Tank P	FO	6.7		6.7										
FO Tank S	FO	6.7		6.7										
Potable Water Tk	Ship's FW	11.9					11.9							
Dispersant Tank	Disp	1.8												1.8
Lube Oil Tank	LO	1.8										1.8		
Total Volume [m ³]			0.0	22.3	0.0	12.2	11.9	0.0	0.0	0.0	0.0	1.8	0.0	1.8
Spec Sheet Total Volume [m ³]			0.0	22.3	0.0	12.2	11.9	0.0	0.0	0.0	0.0	1.8	0.0	1.8

- *Capacities shown are for lead vessel. Actual capacities may vary slightly.
- *Capacities shown in RED are excluded from the total volume.
- *Capacities shown in BLUE are included in another Tank's Capacity.
- *Capacities shown in GREEN are counted for multiple Tank Capacities.