



CINDY BROWN TIDE as shown, LEBOUF TIDE similar

QUALITY 266FT PLATFORM SUPPLY VESSEL

Vessel Characteristics

| | | |
|-------------------|--|--------------------|
| Length, Overall: | 266 ft | 81.1 m |
| Beam: | 56 ft | 17.1 m |
| Depth: | 19.5 ft | 5.9 m |
| Maximum Draft: | 15.9 ft | 4.8 m |
| Light Draft: | 6 ft | 1.8 m |
| Minimum Height: | 71.9 ft | 21.9 m |
| Freeboard: | 3.6 ft | 1.1 m |
| Displacement: | 5,300 lt | 5,380 mt |
| Deadweight: | 3,550 lt | 3,610 mt |
| Clear Deck Space: | 198 x 48 ft | 60 x 15 m |
| Clear Deck Area: | 9,430 ft ² | 880 m ² |
| Deck Strength: | 1,020 lb/ft ² | 5 t/m ² |
| Class Notations: | ABS: FFV-1, +ACC, (E), +AMS, +DPS-2, +A1 | |

Capacities

| | | |
|--------------------------|-----------------------|----------------------|
| Deck Cargo: | 2,460 lt | 2,500 t |
| Fuel Oil: | 142,000 gal | 540 m ³ |
| Potable Water: | 33,100 gal | 130 m ³ |
| Fresh Water: | 314,000 gal | 1,190 m ³ |
| Drill/Ballast Water: | 30,800 gal | 120 m ³ |
| Bulk Tanks (4 tanks): | 6,600 ft ³ | 190 m ³ |
| Liquid Mud (22 lbs/gal): | 11,700 bbl | 1,860 m ³ |
| Methanol: | 2,120 bbl | 340 m ³ |

TIDEWATER

Find out more

tdw.com

Pg.2 Further Specifications
Pg.3 General Arrangement

Pg.4 Capacity Table
Pg.5 DP Capability Plot



Machinery

| | | | |
|----------------------------------|--------------------------|---------|-------|
| Main Engines (2): | CAT 3516C HD Series II | | |
| <i>Total HP:</i> | 5,150 | | |
| Z-Drives: | Yes | | |
| Propellers (2): | Steerprop, 4 Blades, FPP | | |
| Kort Nozzles: | 2 | | |
| Primary Generators (3): | 340 kw | 480 v | 60 hz |
| <i>Driven by:</i> | CAT C18 | | |
| Emergency Generators (1): | 170 kw | 480 v | 60 hz |
| <i>Driven by:</i> | CAT C9 | | |
| Bow Thruster (2): | Rolls Royce CPP 735KW | | |
| <i>Driven by:</i> | CAT Diesel Engines | | |
| <i>Total Thrust:</i> | 24.7 st | 22.4 mt | |

Deck Equipment

| | |
|----------------------|-------------------------------|
| Anchors (2): | 5420 lbs STOCKLESS |
| Anchor Chain: | 250 m of 38 mm chain per side |

Accommodations

| | |
|----------------------------|----------------------------|
| No. of Berths: | 32 |
| Cabins: | 2x1-man, 5x2-man & 5x4-man |
| Certified to Carry: | 32 |
| Galley seating: | 22 |

Registration

| | |
|-------------------------|-----------------------------------|
| Flag: Vanuatu | IMO N^o: 9418535 |
| Year Built: 2010 | Call Sign: YJWT4 |
| Builder: | QUALITY SHIPYARDS |
| Tonnage (ITC): | 2326 GT 697 NT |

Performance*

| | | |
|----------------------------------|---|-------------------------------|
| Fuel Consumption Vs Speed | | |
| <i>Maximum:</i> | 18 m ³ /day (200 gph) @ 12 knots | |
| <i>Cruising:</i> | 10.1 m ³ /day (110 gph) @ 10 knots | |
| <i>Economical:</i> | 4.6 m ³ /day (51 gph) @ 7 knots | |
| Range @ 11 Knots: | 8,850 nm | |
| Transfer Rates | | |
| <i>Fuel Oil:</i> | 650 gpm @ 230 ft | 150 m ³ /h @ 70 m |
| <i>Drill/Ballast Water:</i> | 650 gpm @ 230 ft | 150 m ³ /h @ 70 m |
| <i>Bulk:</i> | 27.5 cfm @ 230 ft | 46.7 m ³ /h @ 70 m |
| <i>Liquid Mud:</i> | 700 gpm @ 180 ft | 160 m ³ /h @ 56 m |
| <i>Methanol:</i> | 600 gpm @ 180 ft | 140 m ³ /h @ 56 m |

Nav/Comms Equipment

| | |
|-----------------------|------------------|
| Radar(s): | 2 |
| Depth Sounder: | 1 |
| Gyro Compass: | 3 |
| Doppler Log: | 1 |
| Radio: | 2 x VHF; 1 x SSB |
| Sat Com: | INMARSAT / VSAT |

Special Equipment

| | |
|--|---|
| Firefighting: | FiFi-1 |
| Dynamic Positioning: | DP-2 CLASSED |
| Ref. Systems: | 2 x MRU; 2 x DGPS 1 x Microwave-based; 1 x Laser-based |
| Mud Circulation System/ Mud Mixers: | Yes/Yes |
| Rescue Boat: | SOLAS Approved |

*Approximate values assuming Ideal Conditions

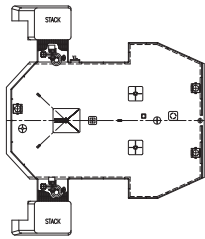
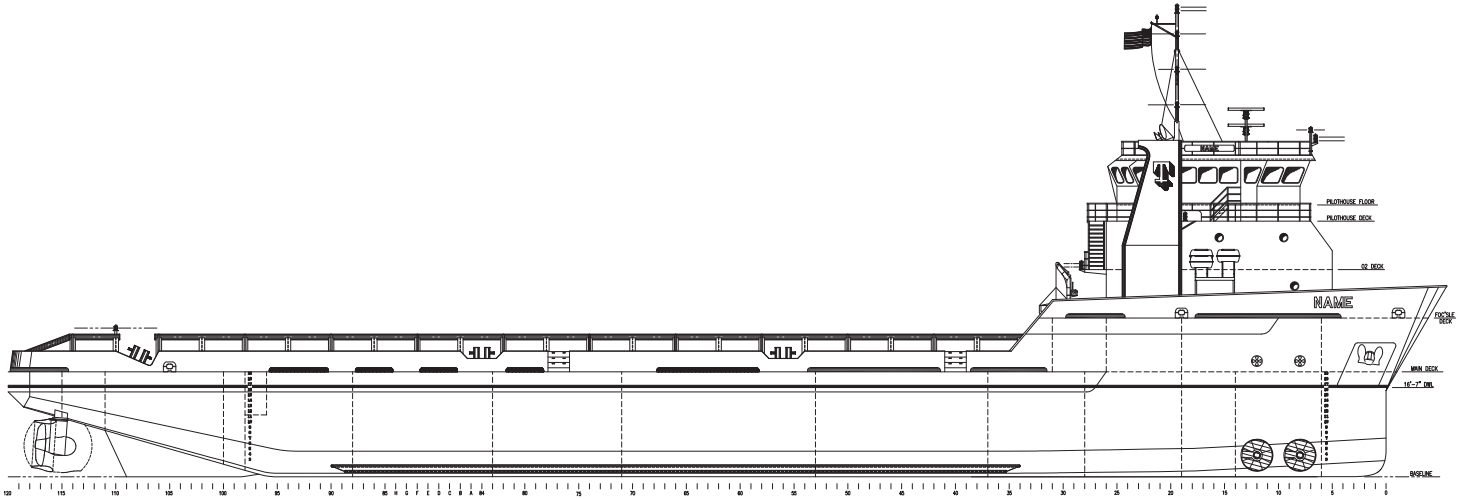

PILOT HOUSE TOP ARRANGEMENTS

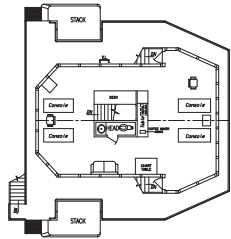

PILOT HOUSE FLOOR ARRANGEMENTS
ELECTRONICS COMPARTMENT BELOW

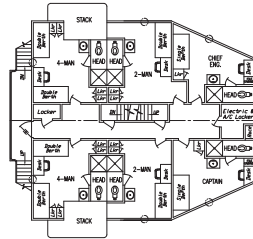

02 DECK ARRANGEMENTS

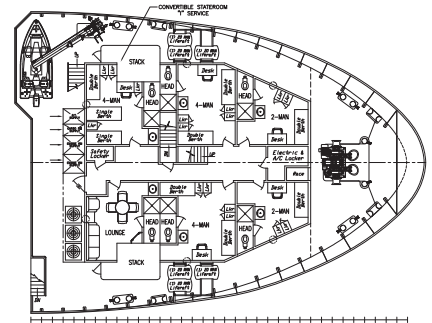

FOC'SLE DECK ARRANGEMENTS

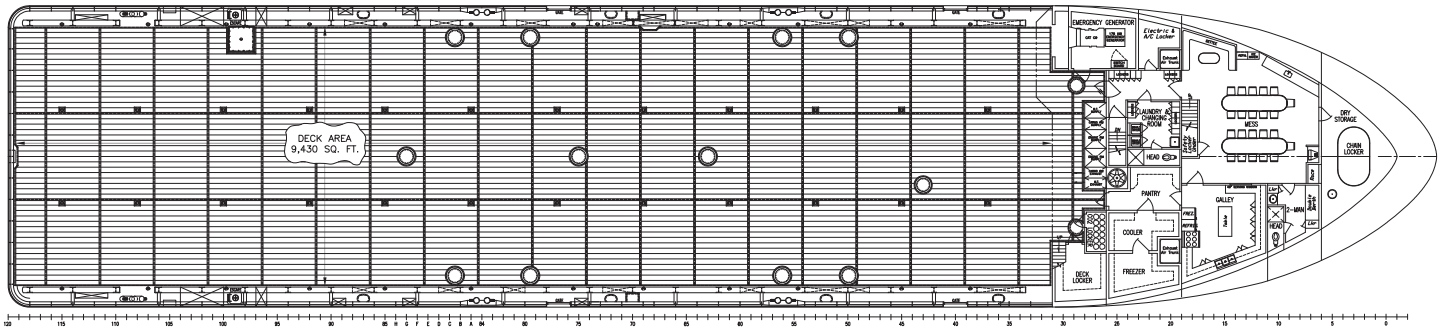

MAIN DECK ARRANGEMENTS

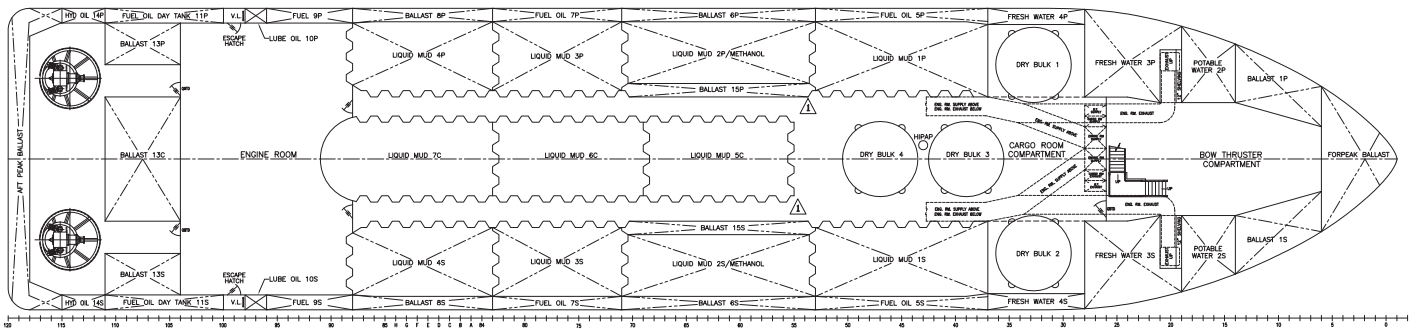

HOLD PLAN (ABOVE DOUBLE BOTTOM)



KONGSBERG

DP Capability Plot QUALITY SHIPYARDS HULL 1271

Case number : 1
Case description : ERN - All thrusters active
Thrusters active : T1-T4
Rudders active :

Input file reference : Foot_3116.scp
Last modified : 2009-05-05 13.54 (v. 2.7.0)

Length overall : 81.4 m
Length between perpendiculars : 75.2 m
Breadth : 17.7 m
Draught : 5.1 m
Displacement : 5091.2 t (Cb = 0.73)
Longitudinal radius of inertia : 18.8 m (= 0.25 * Lpp)
Pos. of origin ahead of Lpp/2 (Xo) : 0.0 m
Wind load coefficients : Calculated (Blendermann)
Current load coefficients : Calculated (Strip-theory)
Wave-drift load coefficients : Database (Scaled by Breadth/Length)

Tidal current direction offset : 0.0 deg
Wave direction offset : 0.0 deg
Wave spectrum type : JONSWAP (gamma = 3.30)
Wind spectrum type : NPD
Current - wave-drift interaction : OFF
Load dynamics allowance : 1.0 * STD of thrust demand
Additional surge force : 0.0 tf
Additional sway force : 0.0 tf
Additional yawing moment : 0.0 tf.m
Additional force direction : Fixed
Density of salt water : 1026.0 kg/m³
Density of air : 1.226 kg/m³ (15 °C)

Power limitations : OFF
Thrust loss calculation : ON

| # | Thruster | X [m] | Y [m] | F+ [tf] | F- [tf] | Max [%] | Pe [kW] | Rudder |
|---|----------|-------|-------|---------|---------|---------|---------|--------|
| 1 | TUNNEL | 34.3 | 0.0 | 10.9 | -10.9 | 100 | 727 | |
| 2 | TUNNEL | 31.7 | 0.0 | 10.9 | -10.9 | 100 | 727 | |
| 3 | AZIMUTH | -36.4 | -5.0 | 33.3 | -20.5 | 100 | 1885 | |
| 4 | AZIMUTH | -36.4 | 5.0 | 33.3 | -20.5 | 100 | 1885 | |

Limiting 1 minute mean wind speed in knots
at 10 m above sea level

ERN (99, 99, 98).
ERN are subject to DNV approval

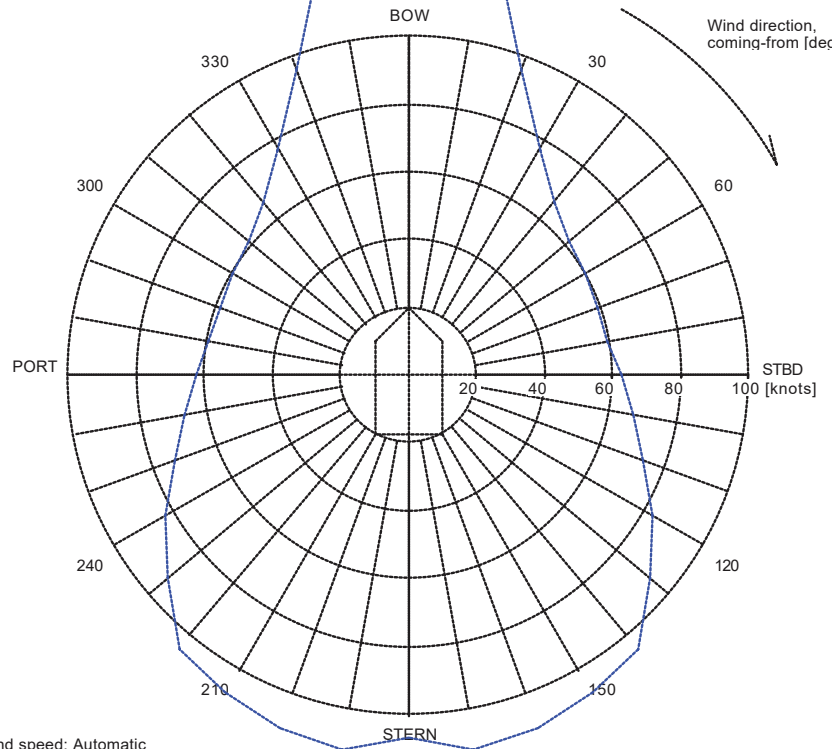

Wind speed: Automatic
Significant wave height: DNV (ERN)
Mean zero up-crossing period: DNV (ERN)

Rotating tidal current: 1.46 knots
Rotating wind induced current: 0.000*Uwi knots